

Ruvitex UK Ltd

# RUVITEX PVC OUTLET ROUND PARAPET L500 D90

## PRODUCT DATASHEET

### RUVITEX PVC OUTLET ROUND PARAPET L500 D90

Ruvitex PVC Outlet Round Parapet L500 D90 Ruvitex through wall outlets are intended to form a watertight seal between Ruvitex roof membranes and external roof drainage pipe work and hoppers.

The smooth internal flange provides a suitable welding area for the Ruvitex roof membrane. The flange and the membrane being welded must be clean and free from contamination prior to welding. Check seam with seam probe after welding.

The round pipe is intended to fit into a wide range of external rain water drainage pipe work. It is important that the shank of the outlet and the drainage pipe work are pushed together firmly and securely to be effective.

d1	d2	d3	L	F1	F2	F3
90mm	83mm	84mm	500mm	130mm	175mm	304mm

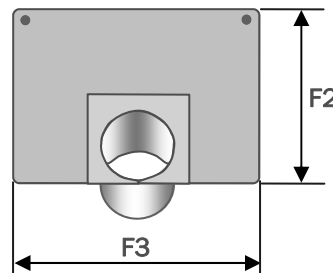
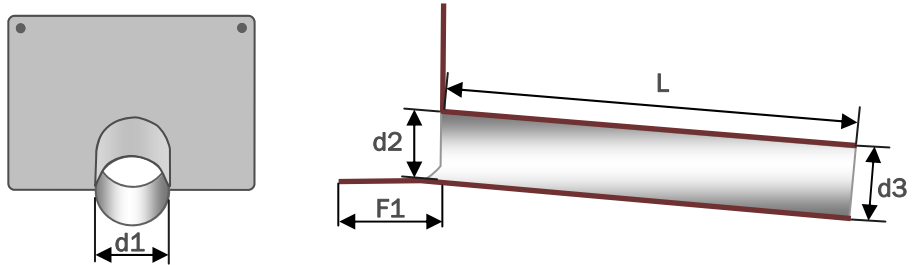

**Ruvitex**

#### RUVITEX UK LTD

Merton House  
38 Merton Way  
West Molesey  
Surrey KT8 1PQ

Phone: +44 (0) 208 941 4298  
Mobile: +44 (0) 7939 353595  
Fax: +44 (0) 872 115 3075  
E-mail: [info@ruvitex.co.uk](mailto:info@ruvitex.co.uk)  
Web: [www.ruvitex.co.uk](http://www.ruvitex.co.uk)

All images are for illustration purpose only and actual products may vary

RUV O RP90 REV 02 11