

Ruvitex UK Ltd

# RUVITEX PVC OUTLET H 240 D 160

## PRODUCT DATASHEET

### RUVITEX PVC OUTLET H240 D160

**Ruvitex PVC Outlet H240 D160** Ruvitex through roof outlets are intended to form a watertight seal between Ruvitex roof membranes and the roof drainage pipe work.

The smooth flange on the top provides a suitable welding area for the Ruvitex roof membrane. The flange and the membrane being welded must be clean and free from contamination prior to welding. Check seam with seam probe after welding.

The two rings on the shank help to form a seal between the roof outlet and the rain water drainage pipe work. It is important that the shank of the outlet and the drainage pipe work are pushed together far enough for the two rings to be effective.

DN	d1	d2	d3	d4	h
160mm	380mm	147mm	141mm	151mm	240mm

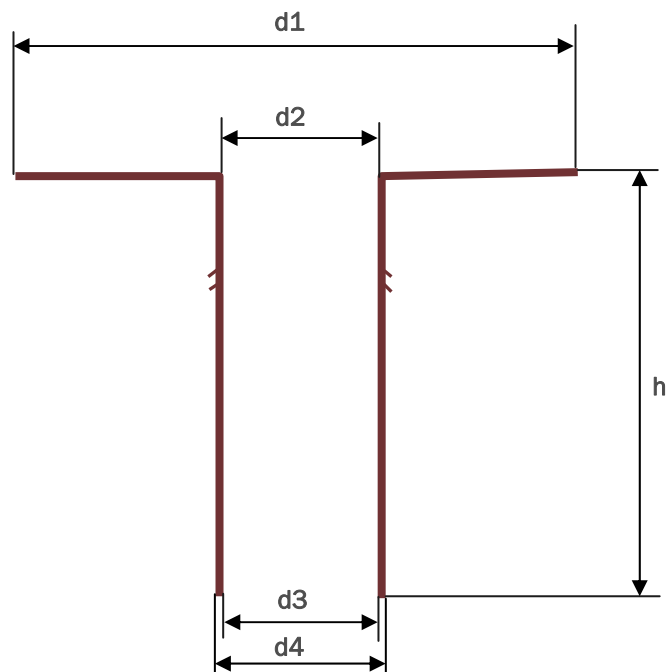

#### RUVITEX UK LTD

Merton House  
38 Merton Way  
West Molesey  
Surrey KT8 1PQ

Phone: +44 (0) 208 941 4298  
Mobile: +44 (0) 7939 353595  
Fax: +44 (0) 872 115 3075  
E-mail: [info@ruvitex.co.uk](mailto:info@ruvitex.co.uk)  
Web: [www.ruvitex.co.uk](http://www.ruvitex.co.uk)